

FCC and IC Compliance Statement

PINPOINT KEY FOB, FCC ID - MVU10148

ACMA: N2523 

IC: 6094A-09291, 6094A-09305

This device complies with part 15 of the FCC Rules. Operation is subject to the following two conditions:

1. This device may not cause harmful interference.
2. This device must accept any interference received including interference that may cause undesired operation.

This device complies with FCC Rules. Changes or modifications not expressly approved by MotorGuide could void the user's authority to operate the equipment.

The MotorGuide Pinpoint GPS System complies with Industry Canada RSS-210 standard. See RSS-GEN 7.1.5. The term "IC:" before the certification/registration number only signifies that registration was performed based on a Declaration of Conformity indicating that Industry Canada technical specifications were met. The term "IC:" before the certification/registration number does not imply that Industry Canada approved the equipment.

EU Compliance Statement

Attwood Corporation hereby declares that the Motorguide Pinpoint GPS System is in compliance with the essential requirements and other relevant provisions of the 99/5/EC R&TTE directive.

A copy of the original CE Declaration of Conformity is on our website at <http://www.motorguide.com/support/certifications>.

Environmental Compliance Statement

All MotorGuide products that are subject to the 2002/96/EC WEEE directive are compliant with the WEEE marking requirement. Such products are marked with the "crossed-out wheelie bin" WEEE symbol (shown, below) in accordance with European Standard EN50419.



54539

The symbol on the product or its packaging indicates that this product must not be disposed of with your other household waste. Instead, it is your responsibility to dispose of your waste equipment by handing it over to a designated collection point for the recycling of waste electrical and electronic equipment. The separate collection and recycling of your waste equipment at the time of disposal will help conserve natural resources and ensure that it is recycled in a manner that protects human health and the environment. For more information about where you can drop off your waste for recycling, please contact your local authority, or where you purchased your product.

Thank You

Thank you for purchasing the MotorGuide Pinpoint GPS Navigation System.

The Pinpoint GPS Navigation System is designed to enhance the precision control and functionality of your MotorGuide trolling motor. We're confident that the Pinpoint GPS will enhance your fishing experience and we appreciate that you chose MotorGuide.

Warranty Message

The product you have purchased comes with a **Limited Warranty** from MotorGuide. The terms of the policy are set forth in the **Warranty Information** section of this manual. The policy statement contains a description of the duration of coverage, **important disclaimers and limitations of damages**, and other related information. Please review this important information.

The description and specifications contained herein were in effect at the time this manual was approved for printing. MotorGuide, whose policy is one of continued improvement, reserves the right to discontinue models at any time, to change specifications, designs, methods, or procedures without notice and without incurring obligation.

MotorGuide, Lowell, Michigan U.S.A.

Mercury Marine

Eagle and Lowrance are registered trademarks of Navico Inc. Garmin is a registered trademark of Garmin Ltd. Humminbird is a registered trademark of Johnson Outdoors Marine Electronics, Inc. Vexilar is a registered trademark of Vexilar, Inc.

Copyright and Trademark Information

© MERCURY MARINE. All rights reserved. Reproduction in whole or in part without permission is prohibited.

Alpha, Axius, Bravo One, Bravo Two, Bravo Three, Circle M with Waves Logo, K-planes, Mariner, MerCathode, MerCruiser, Mercury, Mercury with Waves Logo, Mercury Marine, Mercury Precision Parts, Mercury Propellers, Mercury Racing, MotorGuide, OptiMax, Quicksilver, SeaCore, Skyhook, SmartCraft, Sport-Jet, Verado, VesselView, Zero Effort, Zeus, #1 On the Water and We're Driven to win are registered trademarks of Brunswick Corporation. Pro XS is a trademark of Brunswick Corporation. Mercury Product Protection is a registered service mark of Brunswick Corporation.

Warranty Information

MotorGuide Two Year Limited Warranty.....	1
---	---

Product Installation and Operation

Installing the Pinpoint GPS Modules.....	3
Operating the Pinpoint GPS System.....	11

Owner Service Assistance

Frequently Asked Questions and Troubleshooting.....	25
Service Assistance.....	26
Mercury Marine/MotorGuide Service Offices.....	26

WARRANTY INFORMATION

MotorGuide Two Year Limited Warranty

KEEP YOUR ORIGINAL PURCHASE RECEIPT OR BILL OF SALE.

1. For recreational use customers, Pinpoint GPS components are warranted to the original retail purchaser to be free from defects in material or workmanship for a period of two years from the date of purchase.
2. To obtain warranty service, the purchaser should deliver or return the unit (postage prepaid and insured) to any MotorGuide authorized service dealer. **DO NOT RETURN TO PLACE OF PURCHASE** unless they are an authorized service center. Products returned by mail should be carefully packaged and include a note describing the nature of the problem and/or service requested, customer address, and phone number. A copy of the receipt, bill of sale, registration verification or other proof of purchase is required with the return of the product for warranty consideration. Warranty claims will not be accepted without presentation of purchase receipt for the trolling motor, other verification of registration, or bill of sale for a boat package.
3. MotorGuide, at its discretion, will repair or replace items covered under the terms of this warranty. Neither MotorGuide nor MotorGuide service dealers are responsible for damages to MotorGuide products due to repairs performed by anyone other than an authorized MotorGuide service dealer. Neither MotorGuide nor Attwood is responsible for failure or damage caused by improper installation, set-up, preparation, or previous service or repair errors.
4. For commercial use and government use customers, Pinpoint GPS components are warranted to the original retail purchaser to be free from defects in material or workmanship for one (1) year. Commercial use is defined as any work or employment-related use of the product, or any use of the product which generates income, for any part of the warranty period, even if the product is only occasionally used for such purpose such as rental fleets, guides, fish camps or similar operations. Warranty is not transferable to any subsequent purchaser. The Mercury Product Protection plan is not available to commercial use or government use customers.
5. Warranty coverage is available to customers that purchase from an authorized dealer or retailer that is authorized by MotorGuide to distribute the product in the country in which the sale occurred. Warranty coverage and duration varies by the country in which the owner resides. This Limited Warranty begins on the date the product is first sold to a purchaser or the date on which the product is first put into service, whichever occurs first. The repair or replacement of parts, or the performance of service under this warranty, does not extend the life of this warranty beyond its original expiration date. Promotional warranties are not included in this statement and coverage may vary by promotion. Product either sold or put into service more than six years from date of manufacture is excluded from warranty coverage.
6. We reserve the right to improve the design of any trolling motor or accessory without assuming any obligation to modify any trolling motor or accessory previously manufactured.

WARRANTY INFORMATION

7. This warranty will not apply to: 1) haul-out, launch, towing and storage, transportation charges and/or travel time, telephone or rental charges of any type, inconvenience, or loss of time or income, or other consequential damages; or 2) removal or replacement of boat partitions or material because of boat design for necessary access to the Product; or 3) disconnection and reconnection of hard-wired trolling motors.
8. TERMINATION OF COVERAGE: Warranty coverage may be terminated for repossessed product, or product purchased at auction, from a salvage yard, from a liquidator, from an insurance company, from unauthorized marine dealers or boatbuilders, or other third party entities.
9. ALL INCIDENTAL OR CONSEQUENTIAL DAMAGES ARE EXCLUDED FROM THIS WARRANTY, WARRANTIES OF MERCHANTABILITY AND FITNESS ARE EXCLUDED FROM THIS WARRANTY, IMPLIED WARRANTIES ARE LIMITED TO THE LIFE OF THIS WARRANTY. SOME STATES DO NOT ALLOW LIMITATIONS ON HOW LONG AN IMPLIED WARRANTY LASTS OR THE EXCLUSION OR LIMITATION OF INCIDENTAL OR CONSEQUENTIAL DAMAGES, SO THE ABOVE LIMITATIONS OR EXCLUSIONS MAY NOT APPLY TO YOU. THIS WARRANTY GIVES YOU SPECIFIC LEGAL RIGHTS, AND YOU MAY ALSO HAVE OTHER LEGAL RIGHTS WHICH MAY VARY FROM STATE TO STATE.

For your records:

Model number _____

Serial number _____

PRODUCT INSTALLATION AND OPERATION

Installing the Pinpoint GPS Modules

⚠ WARNING

Before working around electrical system components, disconnect the battery cables from the battery to prevent injury or damage to the electrical system due to an accidental short circuit.

1. Starting with the negative (-) lead, disconnect the trolling motor battery cables from the battery, or unplug the trolling motor from the boat's power receptacle.
2. Remove the five screws from under the trolling motor head. Remove the cover from the trolling motor head.

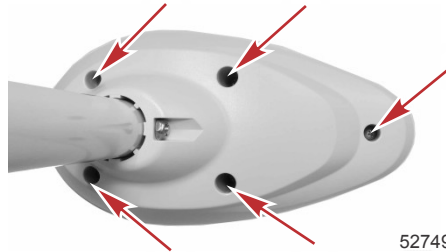

Screw locations—under trolling motor head

3. Remove the cable grommet from the trolling motor head.

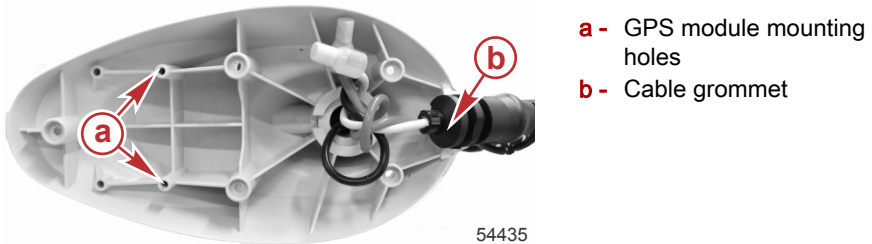

4. Place the upper GPS module into the trolling motor head as shown, with the GPS cable exiting the module from below. Secure the upper GPS module to the trolling motor head with two mounting screws. Push the power wires to one side to ease installation of the GPS cable. Route the GPS cable out of the trolling motor head, through the slot in the cable grommet as shown.

NOTE: The cable grommet is molded to allow the GPS cable to be routed under it.

PRODUCT INSTALLATION AND OPERATION

IMPORTANT: Do not overtighten the mounting screws or use power tools to tighten the screws.

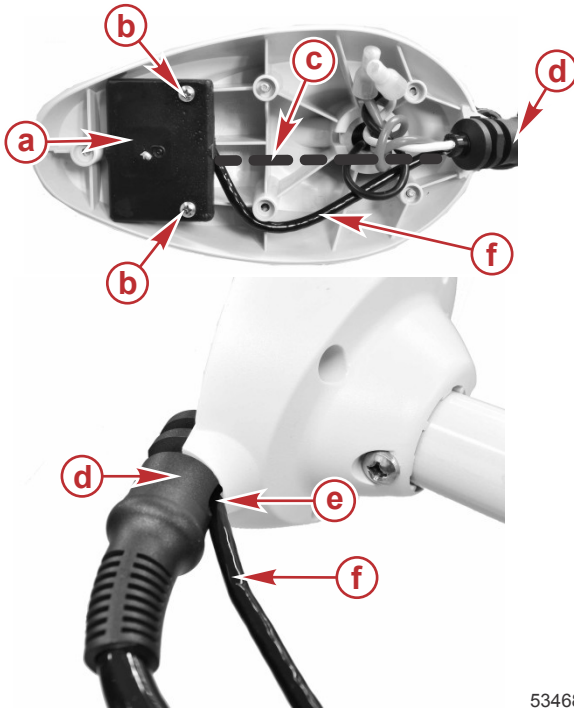

- a** - Upper GPS module
- b** - Mounting screws (2)
- c** - Incorrect GPS cable routing—do not install the cable here
- d** - Cable grommet
- e** - Unused slot for sonar cable
- f** - GPS cable

53468

5. Place the cover onto the trolling motor head. Ensure that the cable grommet is seated in the trolling motor head and that no wires are pinched. Install the five screws that secure the cover to the trolling motor head.

IMPORTANT: Do not overtighten the screws or use power tools to tighten the screws.

PRODUCT INSTALLATION AND OPERATION

6. Extend the trolling motor column so that the coiled power cable is as long as possible. Starting from the trolling motor head, wrap the coiled GPS cable around each coil of the power cable until you reach the lower mount. This will place the coiled GPS cable inside the coils for the power cable.

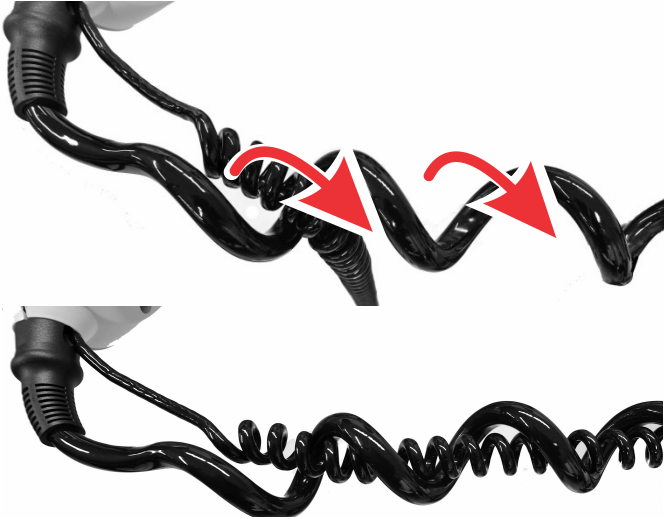

54436

7. Remove the side panel screws from each side of the trolling motor. Gently pull the side panels away from the mount, taking care not to damage the locating tabs, and remove the side panels from both sides of the trolling motor.

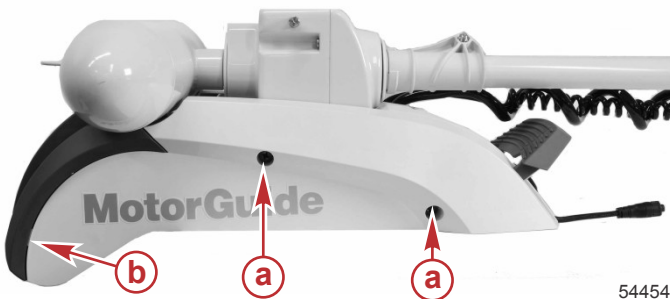

54454

- a** - Side panel screws
- b** - Locating tab

PRODUCT INSTALLATION AND OPERATION

8. Remove the status indicator light panel from the trolling motor by lifting it up, then rotating it to clear the foot release lever. Do not unplug the status indicator light panel from the trolling motor.



9. Install the lower GPS module into the empty slot into the trolling motor base in the following order:

- Place the lower GPS module gently into the empty slot. Route the NMEA cable through the slots as shown, with the connector exiting the trolling motor base.

NOTE: If the NMEA cable will not be used, it can be coiled and left inside the trolling motor base.

- Remove the cap from the female GPS connector.
- Route the male GPS connector through the slot, and connect it to the female GPS connector by aligning the pins and locating tabs in the connectors. Press the connectors together, then turn the nut 1/4 turn to the right until it locks.
- Gently press the lower GPS module into the opening until it is fully seated.

PRODUCT INSTALLATION AND OPERATION

- Remove the plastic plug, and route the GPS cable through the opening in the trolling motor base.

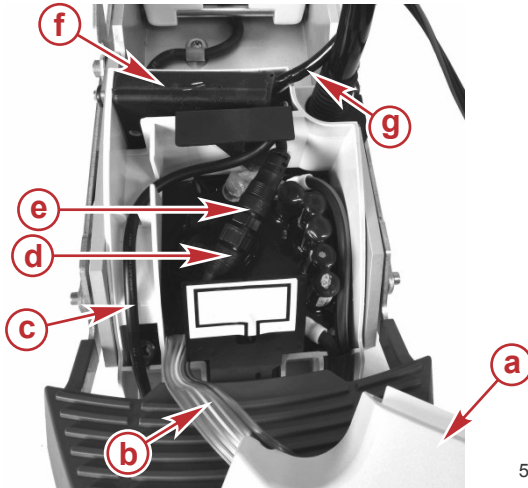

53470

- a** - Status light indicator panel
- b** - Status light harness
- c** - NMEA cable
- d** - Female GPS connector
- e** - Male GPS connector
- f** - Lower GPS module
- g** - GPS cable

10. Install the status indicator light panel. Ensure that no wires are pinched between the status indicator light panel and the trolling motor, and that the GPS cable is positioned as shown.

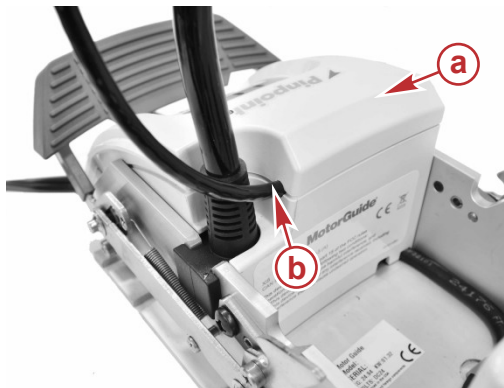

54438

- a** - Status indicator light panel
- b** - GPS cable

PRODUCT INSTALLATION AND OPERATION

11. Install the side panels onto the trolling motor. Ensure that the status indicator light panel is seated between the side panels as shown, and that no wires are pinched.

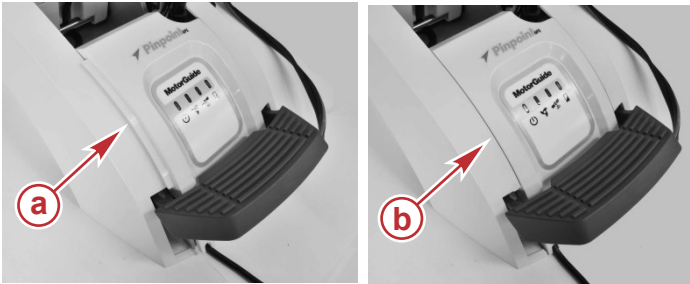

54529

- a** - Status indicator light panel not seated—incorrect
 - b** - Status indicator light panel seated between side panels—correct
12. Ensure that no wires are pinched between the side panels and the trolling motor. Tighten the side panel mounting screws.

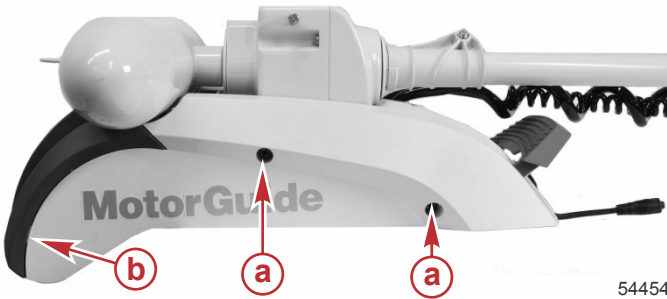

54454

- a** - Side panel screws
- b** - Locating tab

LINKING THE HANDHELD REMOTE TO THE TROLLING MOTOR

The first time the trolling motor is powered up, the handheld remote will need to be linked to the trolling motor. The linking procedure is listed as follows:

1. Starting with the positive (+) lead, connect the trolling motor power cables to the battery.

PRODUCT INSTALLATION AND OPERATION

2. Within ten seconds after connecting the power cables, press the **left arrow** button and **right arrow** button on the handheld remote at the same time. The trolling motor will emit a low tune to confirm that the handheld remote has been linked to the trolling motor.

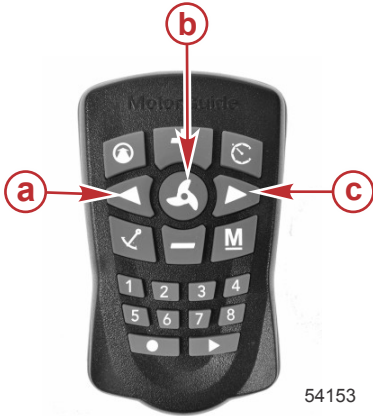

- a - Left arrow button
- b - Propeller button
- c - Right arrow button

If you wish to clear the linked handheld from the trolling motor's memory, press the **left arrow**, **right arrow**, and **propeller** buttons at the same time. You will need to complete the link procedure again to use the handheld remote with the trolling motor.

MOUNTING ANGLE CALIBRATION

IMPORTANT: This calibration is required and is normally completed once when the GPS modules are installed. It should be repeated when the trolling motor is moved from one boat to another. This calibration can be done with the boat in or out of the water.

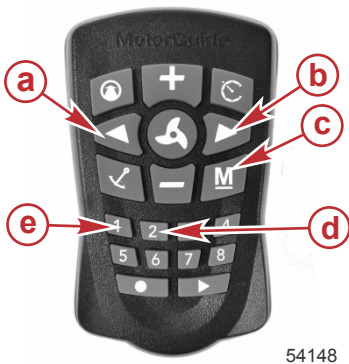

- a - Left turn
- b - Right turn
- c - Manual mode
- d - #2 button
- e - #1 button

IMPORTANT: A fixed GPS position is required to complete the mounting angle calibration. The Xi5 will emit an audible tune once it has acquired a fixed GPS position (in the default audio mode), and the GPS status indicator light will illuminate.

PRODUCT INSTALLATION AND OPERATION

1. Power up and deploy the trolling motor. Adjust the motor height so that the motor is clear of any obstructions while turning.

IMPORTANT: Stay a safe distance away from the propeller—the trolling motor is in an operational mode.

⚠ WARNING

Rotating propellers can cause serious injury or death. Never start or operate the motor out of water.

2. Use the **left turn** and **right turn** buttons to steer the unit so that it is facing straight ahead, parallel with the keel of the boat, with the nose cone of the lower unit facing forward and the propeller facing aft.

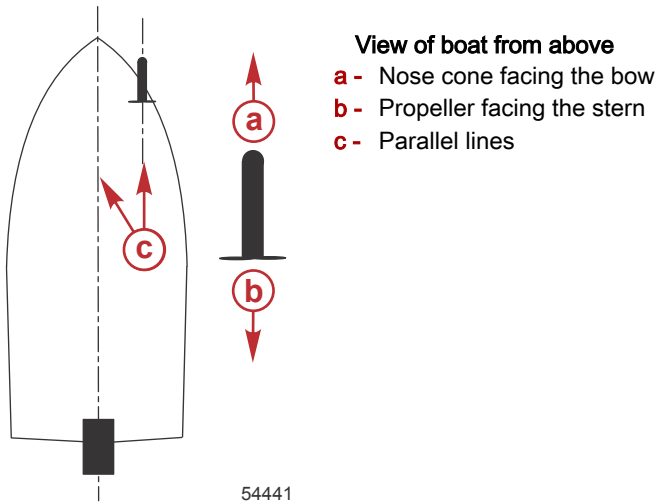

3. Once the lower unit is positioned as close to parallel with the keel as possible, press and hold the **manual mode** button, then press and release the **1, 1**, then **2** buttons in sequence. The trolling motor will emit an audible tune, flash the status indicator light, and then return to manual mode, completing the mounting angle calibration.

COMPASS CALIBRATION

IMPORTANT: This calibration is completed at the factory. It should only be repeated if the Pinpoint GPS system is not responding properly. This calibration must be done with the boat in the water, using the primary propulsion engine.

PRODUCT INSTALLATION AND OPERATION

IMPORTANT: A fixed GPS position is required to complete the compass calibration. The Xi5 will emit an audible tune once it has acquired a fixed GPS position (in the default audio mode), and the GPS status indicator light will illuminate.

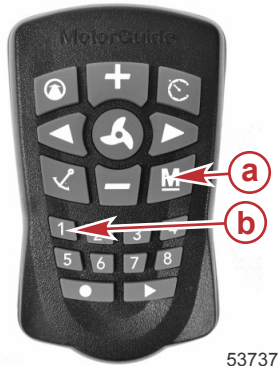

a - Manual mode

b - #1 button

1. Locate a suitable area clear of obstructions to navigation (both above and below the waterline) to perform the compass calibration.
2. Deploy the trolling motor. Verify that you are in a location where your trolling motor and primary propulsion engine will not hit bottom or other obstructions.
3. Press and hold the **manual mode** button, then press **1, 1, 1**. The trolling motor will emit three ascending-tone beeps.
4. Use the primary propulsion engine to slowly drive the boat in two complete circles. The trolling motor will emit a tune when the compass calibration is complete.

RESET TO FACTORY CALIBRATION

To reset the trolling motor to the factory calibration, press and hold the **manual mode** button, then press **1, 1, 4**.

Operating the Pinpoint GPS System

PINPOINT GPS STARTUP

The global positioning system (GPS) is a satellite-based navigation system capable of providing positional information anywhere on Earth, provided that the GPS receiver has a clear line of sight to at least four GPS satellites.

PRODUCT INSTALLATION AND OPERATION

When the trolling motor is powered up and deployed, it is immediately capable of operating as a conventional trolling motor. The trolling motor will require approximately 30 seconds to acquire a fixed GPS position. Having a clear view of the sky overhead, with no large trees, power lines, bridges, or buildings to interfere with the GPS signal, will improve the GPS accuracy and reduce the amount of time required to obtain a fixed GPS position. Once the unit has acquired a fixed GPS position, the GPS accuracy will continually improve for several minutes. It is recommended to power up the trolling motor as soon as possible before operation to allow the fixed GPS position to become as accurate as possible.

Power up the trolling motor by connecting the battery cables to the trolling motor batteries, or plugging the trolling motor into the trolling motor power plug (if equipped). The trolling motor will emit audio signals to make the operator aware of its status.

- The trolling motor will emit one beep when it is powered up.
- The trolling motor will emit a three-beep tune once it has acquired a fixed GPS position, and the GPS status indicator light will illuminate.

OPERATING IN MANUAL MODE

In manual mode, the trolling motor operates like a conventional trolling motor. It allows the operator to manually control the direction of travel and thrust level of the trolling motor, using the directional controls on the handheld remote or wireless foot pedal. Refer to the following illustration and instructions to operate the trolling motor in manual mode with the handheld remote.

Once the trolling motor is powered up, it is ready to operate in manual mode. Manual mode is the default mode after power-up, and also if the GPS signal is lost while in a GPS operating mode. The trolling motor will emit one beep to indicate its status in manual mode. To enter manual mode from another mode, press the **manual mode** button.

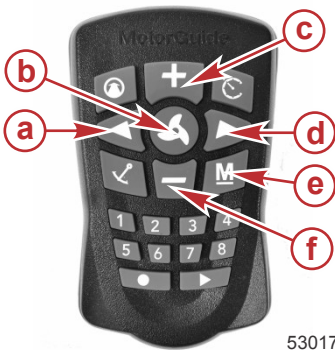

- a - Left turn
- b - Propeller on/off
- c - Increase speed
- d - Right turn
- e - Manual mode
- f - Decrease speed

53017

PRODUCT INSTALLATION AND OPERATION

Turning the Handheld Remote On or Off

The handheld remote is always on, and is ready for use anytime that the trolling motor is powered up and in the deployed position.

Steering

- To turn left, press the **left turn** button on the handheld remote.
- To turn right, press the **right turn** button on the handheld remote.
- The available steering range allows the trolling motor to turn beyond 180° for operation in reverse.

Speed Control

- Press the **propeller on/off** button once to start the propeller, and press the **propeller on/off** button again to stop the propeller.
- The trolling motor will emit a two-beep tone when the propeller is started, and the propeller status indicator light on the trolling motor will illuminate.
- The trolling motor will emit a two-beep tone when the propeller is stopped, and the propeller status indicator light will turn off.
- The system is equipped with 20 speed levels. Press the **increase speed (+)** button to increase motor speed by one level, and press the **decrease speed (-)** button to reduce the motor speed by one level.
- Holding the **increase speed (+)** or **decrease speed (-)** buttons will cause the speed level to increase or decrease until the speed level is reached. Holding the **increase speed (+)** or **decrease speed (-)** button for 2.5 seconds will increase the speed level from 0% to 100%, or decrease from 100% to 0%, respectively. The trolling motor will emit two beeps when it reaches the 100% or 0% speed level.
- The trolling motor will emit two beeps if the user tries to increase or decrease the motor speed beyond its limits.

ANCHOR MODE

Operating in Anchor Mode

Anchor mode allows the boat's bow to remain in a fixed location, and will automatically account for wind and current changes to keep the boat in the selected location, using the trolling motor steering and speed controls. In order for anchor mode to operate, the Pinpoint GPS system must have achieved a fixed GPS location, indicated by the trolling motor emitting a three-beep tune, and the GPS status indicator light will illuminate.

PRODUCT INSTALLATION AND OPERATION

⚠ WARNING

Avoid serious injury from colliding with other boats, running aground, or striking objects in the water. The Pinpoint GPS system cannot detect other boats, shallow water, or objects in the water. Always beware of possible obstructions to navigation when operating in any Pinpoint GPS mode.



- a - Anchor mode
- b - Manual mode

⚠ WARNING

A spinning propeller, a moving boat, or any solid device attached to the boat can cause serious injury or death to swimmers. Stop the trolling motor immediately whenever anyone in the water is near your boat.

Setting the Anchor

Press the **anchor mode** button to place the system in anchor mode. When the **anchor mode** button is pressed, the system will lock onto the fixed GPS position at the moment that the button was pressed. The trolling motor will emit one ascending chirp to indicate its status in anchor mode, and the GPS status indicator light will blink slowly.

While anchor mode holds the boat in the selected position, the boat may rotate or pivot around the trolling motor's steering axis. The orientation of the boat will follow the wind and/or current.

Exiting Anchor Mode

Press the **anchor mode** button again or press the **manual mode** button. The trolling motor will emit a descending chirp and the GPS status indicator light on the trolling motor will stop blinking and remain on.

PRODUCT INSTALLATION AND OPERATION

Adjusting the Anchor Position

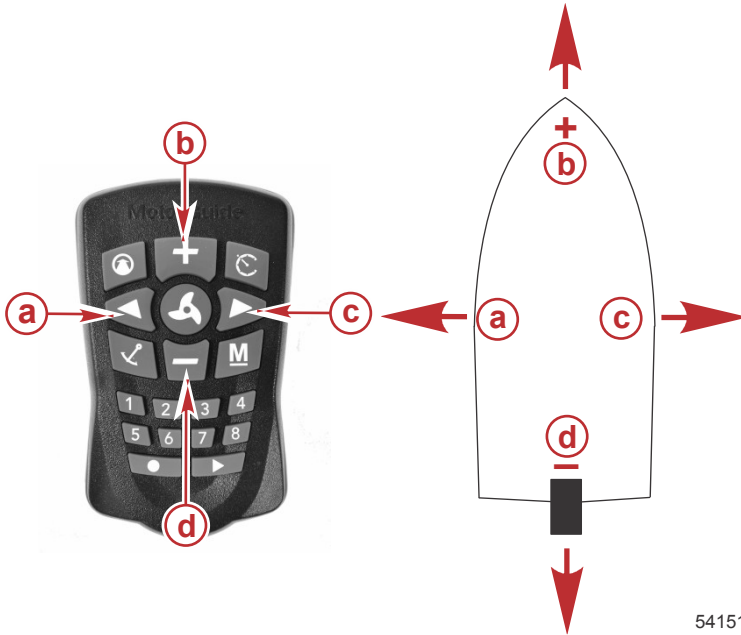

54151

- a** - Left turn—"jog" left
- b** - Increase speed—"jog" ahead
- c** - Right turn—"jog" right
- d** - Decrease speed—"jog" behind

Once the trolling motor is in anchor mode, the anchor position can be adjusted by pressing any of the four buttons indicated above. Pressing the **left turn**, **right turn**, **increase speed (+)**, or **decrease speed (-)** buttons once will adjust the anchor position by five feet in the direction selected, relative to the boat's heading. For example, pressing the **+** button once will move the anchor position forward of the bow by five feet.

NOTE: Pressing a button multiple times will move the anchor position five feet for each time the button is pressed.

PRODUCT INSTALLATION AND OPERATION

Storing or Overwriting an Anchor Position



a - Memory buttons (1–8)

NOTE: An anchor position can be stored or overwritten from any operating mode except route record mode.

To store an anchor location, press and hold any of the numbered **memory** buttons for two seconds. The unit will emit a tune to indicate that the anchor position has been stored successfully.

A stored anchor position can be overwritten by simply storing a new anchor position to the desired **memory** button.

Recalling a Stored Anchor Position

NOTE: A stored anchor position can be recalled from any operating mode.

To recall a stored anchor position, press and release the desired **memory** button. The trolling motor will emit an ascending chirp to indicate that a stored anchor position has been retrieved. If the selected anchor position button does not have a stored anchor position, or if the anchor location is over one mile away from your current location, the trolling motor will emit an error tone.

IMPORTANT: If the trolling motor loses the GPS signal while in any GPS mode, the trolling motor will emit an error tone and automatically return to manual mode.

IMPORTANT: When recalling a stored anchor position, the system will calculate a straight-line course from your current position to the selected anchor position. Ensure that there are no obstructions to navigation between your location and the selected anchor position—the system will recall an anchor point even if obstructions are present. If obstructions are encountered, navigate around them by operating in manual mode.

PRODUCT INSTALLATION AND OPERATION

⚠ WARNING

Avoid serious injury from colliding with other boats, running aground, or striking objects in the water. The Pinpoint GPS system cannot detect other boats, shallow water, or objects in the water. Always beware of possible obstructions to navigation when operating in any Pinpoint GPS mode.

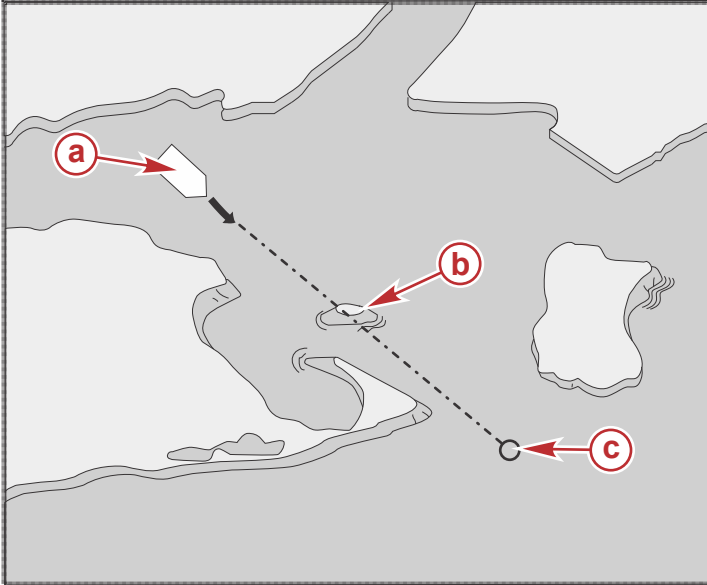

54421

Course shown has an obstruction to navigation

- a** - Current position of the boat
- b** - Obstruction to navigation
- c** - Selected anchor position

OPERATING IN HEADING LOCK MODE

In heading lock mode, the trolling motor has the capability to lock in the trolling motor's heading, navigating along a straight line, and is able to compensate for current and wind conditions. The operator is able to adjust the speed and the heading by using the handheld remote.

PRODUCT INSTALLATION AND OPERATION

⚠ WARNING

Avoid serious injury from colliding with other boats, running aground, or striking objects in the water. The Pinpoint GPS system cannot detect other boats, shallow water, or objects in the water. Always beware of possible obstructions to navigation when operating in any Pinpoint GPS mode.

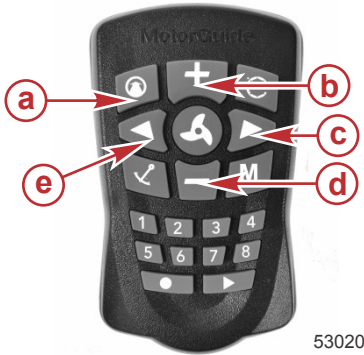

- a - Heading lock mode
- b - Increase speed (+)
- c - Right turn
- d - Decrease speed (-)
- e - Left turn

Heading Lock Operation

IMPORTANT: If the trolling motor loses the GPS signal while in any GPS mode, the trolling motor will emit an error tone and automatically return to manual mode.

To operate the trolling motor in heading lock mode, steer the trolling motor so that it is pointing in the desired direction of travel, then press the **heading lock** button on the handheld remote. At that moment, the trolling motor will project a straight line corresponding to the direction that the trolling motor is pointing and begin navigating along that line. The trolling motor will automatically steer to maintain navigation along that projected line. The trolling motor will emit an ascending chirp to indicate its status in heading lock mode and the GPS status indicator light will blink slowly.

The heading lock automatically adjusts for current and wind conditions. The trolling motor will drive the bow of the boat along this course, while the boat itself may be askew to the direction of travel due to current or wind conditions. In heading lock mode, steering control is automatic and motor speed is user-selectable. In extreme current or wind conditions, it may be necessary to increase the motor speed to maintain the desired heading.

To exit heading lock mode, press the **heading lock** button or the **manual mode** button. The trolling motor will emit a descending chirp and the GPS status indicator light will stop blinking.

PRODUCT INSTALLATION AND OPERATION

Adjusting Motor Speed

If heading lock mode is selected from manual mode, the trolling motor will run at the last selected speed. The motor speed can be manually adjusted in heading lock mode by pressing the **increase speed (+)** button or **decrease speed (-)** button. The trolling motor will emit two beeps when the user tries to exceed the available motor speed limits.

Adjusting the Heading

While in heading lock mode, the heading can be adjusted by pressing the **left turn** or **right turn** buttons on the handheld remote. The trolling motor will resume heading lock navigation based on the new trolling motor heading.

OPERATING IN ROUTE MODE

Route mode has the ability to store and recall user-defined routes. These routes can be recorded and recalled by the user from any operating mode.

⚠ WARNING

Avoid serious injury from colliding with other boats, running aground, or striking objects in the water. The Pinpoint GPS system cannot detect other boats, shallow water, or objects in the water. Always beware of possible obstructions to navigation when operating in any Pinpoint GPS mode.



- a - Memory buttons (1–8)
- b - Route playback
- c - Route record

53021

PRODUCT INSTALLATION AND OPERATION

Storing and Overwriting a Route

A route can be stored from any mode by pressing the **route record** button. The trolling motor will emit a tune when the **route record** button is pressed. Once the **route record** button is pressed, begin navigating along your desired course. You can switch between manual mode and heading lock mode at any time while recording a route. The trolling motor will emit one beep (and the GPS status indicator light will blink) for every 2 m (6.5 ft) traveled while recording. Press and hold any of the numbered **memory** buttons to stop recording and store the route to the selected **memory** button. The trolling motor will emit a tune to confirm that it has stored the route. The trolling motor can store up to eight routes, each up to 6.4 km (4 miles) in length.

Overwriting a stored route is accomplished using the same procedure as storing a new route.

Recalling a Stored Route

A stored route can be recalled while operating in any mode by pressing the **route playback** button, then pressing the desired **memory** button. The trolling motor will emit an ascending chirp to indicate that the route has been successfully recalled.

IMPORTANT: When recalling a stored route, the system will calculate a straight-line course from your current position to the nearest point on the recalled route. Ensure that there are no obstructions to navigation between your current position and the recalled route. The system will recall a stored route even if obstructions are present. If obstructions are encountered, navigate around them by operating in manual mode.

PRODUCT INSTALLATION AND OPERATION

⚠ WARNING

Avoid serious injury from colliding with other boats, running aground, or striking objects in the water. The Pinpoint GPS system cannot detect other boats, shallow water, or objects in the water. Always beware of possible obstructions to navigation when operating in any Pinpoint GPS mode.

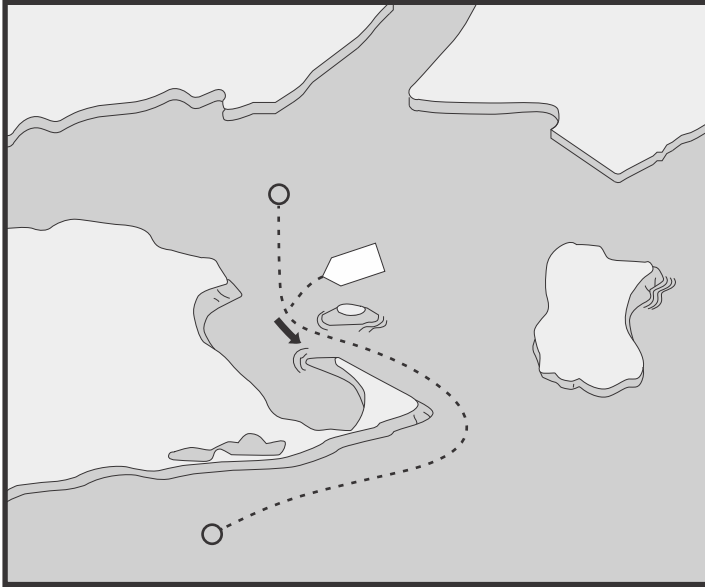

53022

Recalling a stored route—Beware of possible obstructions to navigation

If the selected memory position is empty, or if the boat is over 1.6 km (1 mile) from a point on the selected route, the trolling motor will emit an error tone and exit the route mode.

IMPORTANT: If the trolling motor loses the GPS signal while in any GPS mode, the trolling motor will emit an error tone and automatically return to manual mode.

When recalling a stored route, the trolling motor will navigate to the nearest point on the route, then travel to the most distant end from the boat's current position. At any time while traveling along a stored route, the direction of travel can be reversed by recalling the stored route again. Once you have reached the end of a stored route, the trolling motor will set anchor in the anchor mode and will emit an ascending chirp to indicate that the boat has arrived at the end of the stored route.

PRODUCT INSTALLATION AND OPERATION

USING CRUISE CONTROL

Cruise control can be activated while in heading lock mode or route playback mode to maintain a constant trolling speed. It will automatically adjust the motor speed to correct for current and wind conditions to maintain a constant speed.

⚠ WARNING

Avoid serious injury from colliding with other boats, running aground, or striking objects in the water. The Pinpoint GPS system cannot detect other boats, shallow water, or objects in the water. Always beware of possible obstructions to navigation when operating in any Pinpoint GPS mode.

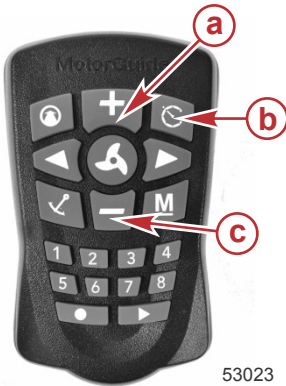

- a - Increase speed (+)
- b - Cruise control
- c - Decrease speed (-)

Setting Cruise Control

While in heading lock mode or route recall mode, you can set the cruise control by pressing the **cruise control** button. The trolling motor will emit one ascending chirp to indicate that the cruise control has been activated. The system will automatically set a trolling speed of 1.0 mph (1.6 kph) and will compensate for current and wind conditions to maintain this speed. Pressing the **cruise control** button again will turn the cruise control off, indicated by a descending chirp from the trolling motor.

While cruise control is turned on, the GPS speed over ground can be adjusted by pressing the **increase speed (+)** or **decrease speed (-)** buttons. Pressing either button once will adjust the speed by 0.1 mph (0.16 kph) accordingly. For example, to set the cruise control at 1.3 mph (2.1 kph), press the **cruise control** button, then press the **increase speed (+)** button three times.

IMPORTANT: If the trolling motor loses the GPS signal while in any GPS mode, the trolling motor will emit an error tone and automatically return to manual mode.

PRODUCT INSTALLATION AND OPERATION

SELECTING THE AUDIO MODE

The Pinpoint GPS system has three user-selectable audio modes to choose from. These audio modes provide audible confirmation of selected modes, speeds, and button selections.

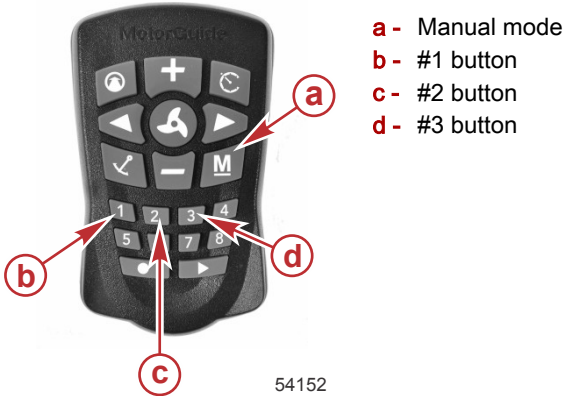

Audio mode 1 can be selected by pressing and holding the **manual mode** button, then pressing **1, 3, 1**.

Audio mode 2 can be selected by pressing and holding the **manual mode** button, then pressing **1, 3, 2**.

Audio mode 3 can be selected by pressing and holding the **manual mode** button, then pressing **1, 3, 3**.

Condition	Audio Pattern	Audio Mode 1 (Default)	Audio Mode 2	Audio Mode 3
Startup	1 beep	Yes	Yes	Yes
Remote learn confirmation	Low tune	Yes	Yes	Yes
User invalid command (No GPS fix)	Error beep	Yes	Yes	Yes
GPS fix acquired	High tune	Yes	Yes	–
Loss of GPS fix	Error	Yes	Yes	–
Speed + (when less than maximum speed)	Short beep	–	Yes	–
Speed + (at maximum speed)	2 beeps	Yes	Yes	–

PRODUCT INSTALLATION AND OPERATION

Condition	Audio Pattern	Audio Mode 1 (Default)	Audio Mode 2	Audio Mode 3
Speed – (when greater than speed level 0)	Short beep	–	Yes	–
Speed – (at speed 0)	2 beeps	Yes	Yes	–
Pressing the propeller on/off button to turn the propeller on	2 beeps up	Yes	Yes	–
Pressing the propeller on/off button to turn the propeller off	2 beeps down	Yes	Yes	–
Momentary propeller	None	–	–	–
Record Route Enable	Tune	Yes	Yes	–
Record Route Save	Tune	Yes	Yes	–
Recall Route Enable	Chirp up	Yes	Yes	–
Recall Route Disable	Chirp down	Yes	Yes	–
Reach End of Route	Chirp up	Yes	Yes	–
Heading Lock Enable	Chirp up	Yes	Yes	–
Heading Lock Disable	Chirp down	Yes	Yes	–
Cruise Control Enable	Chirp up	Yes	Yes	–
Cruise Control Disable	Chirp down	Yes	Yes	–
Anchor Enable	Chirp up	Yes	Yes	–
Anchor Disable	Chirp down	Yes	Yes	–
Record Anchor Position	Tune	Yes	Yes	–
Anchor Recall	Chirp up	Yes	Yes	–
Recalling an anchor point or route more than one mile away	Error	Yes	Yes	Yes

OWNER SERVICE ASSISTANCE

Frequently Asked Questions and Troubleshooting

This section is focused on questions and troubleshooting advice for the Pinpoint GPS. Refer to **Owner Service Assistance** in the **Xi5 Wireless Owners and Installation Manual** for trolling motor troubleshooting assistance.

Why does the trolling motor emit a tune a few moments after I power it up?

The GPS has acquired a fixed position. Refer to the **Pinpoint GPS Startup** section of this manual.

When I recall a stored anchor position, the trolling motor emits an error tone and will not navigate to my anchor position. Why is that?

The anchor position you chose to recall is over one mile away from your current location, or the system has not acquired a fixed GPS position. Refer to the **Operating in Anchor Mode** section of this manual.

When I try to recall a stored route, the trolling motor emits an error tone and will not navigate along my route. Why is that?

You are more than one mile away from the nearest point on the selected route, or the system has not acquired a fixed GPS position. Refer to the **Operating in Route Mode** section of this manual.

Why did the handheld remote stop working?

Several conditions can cause the handheld remote to stop working. Verify that the trolling motor is locked in the deployed position. Cycle the trolling motor power off, then back on. Finally, check the battery in the handheld remote and replace it if necessary.

The Pinpoint GPS will not store an anchor point, recall a route, or hold a heading lock. Why is that?

The GPS has not acquired a fixed GPS position. Allow at least 60 seconds for the GPS system to acquire a fixed GPS position. Listen for a three-beep tune, and also look for the GPS status indicator light to illuminate, indicating that the system has acquired a fixed GPS position. Also, verify that no obstructions are overhead (such as bridges, buildings, large trees, etc.) blocking the GPS antenna's view of the sky overhead.

After selecting a mode, the trolling motor emits an error tone, then does nothing. What is wrong?

The GPS has not acquired a fixed GPS position, the trolling motor battery voltage is low, or there is a loose battery connection. Listen for a three-beep tune, and also look for the GPS status indicator light to illuminate, indicating that the system has acquired a fixed GPS position. Check all connections. Charge the batteries and test for a bad battery if the trouble persists.

OWNER SERVICE ASSISTANCE

Service Assistance

Your satisfaction with your product is very important to us. If you have a problem or question about your motor, contact your dealer or any certified MotorGuide Service Center. For more service assistance information, refer to **Warranty Information**.

The following information will be needed by the service office:

- Your name and address
- Daytime telephone number
- Model and serial number of your trolling motor
- Proof of purchase or registration verification
- Nature of problem

Mercury Marine/MotorGuide Service Offices

For assistance, call, fax, or write. Please include your daytime telephone number with mail and fax correspondence.

United States, Canada		
Telephone	English - (920) 929-5040 Français - (905) 636-4751	Mercury Marine W6250 W. Pioneer Road P.O. Box 1939 Fond du Lac, WI 54936-1939
Fax	English - (920) 929-5893 Français - (905) 636-1704	
Website	www.motorguide.com	

Australia, Pacific		
Telephone	(61) (3) 9791-5822	Brunswick Asia Pacific Group 41-71 Bessemer Drive Dandenong South, Victoria 3175 Australia
Fax	(61) (3) 9706-7228	

Europe, Middle East, Africa		
Telephone	(32) (87) 32 • 32 • 11	Brunswick Marine Europe Parc Industriel de Petit-Rechain B-4800 Verviers, Belgium
Fax	(32) (87) 31 • 19 • 65	

Mexico, Central America, South America, Caribbean		
Telephone	(954) 744-3500	Mercury Marine 11650 Interchange Circle North Miramar, FL 33025 U.S.A.
Fax	(954) 744-3535	

OWNER SERVICE ASSISTANCE

Japan		
Telephone	072-233-8888	Kisaka Co., Ltd. 4-130 Kannabecho Sakai-shi Sakai-ku 5900984 Osaka, Japan
Fax	072-233-8833	

Asia, Singapore		
Telephone	(65) 65466160	Brunswick Asia Pacific Group T/A Mercury Marine Singapore Pte Ltd 29 Loyang Drive Singapore, 508944
Fax	(65) 65467789	